

BASIC CYLINDER

MBH SERIES - HYDRAULIC CYLINDERS

CAP END CLEVIS (CM/EM)

SPECIFICATIONS

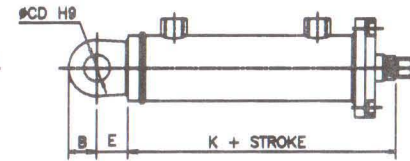
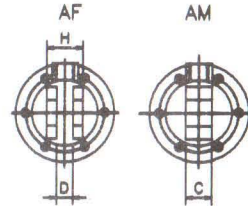
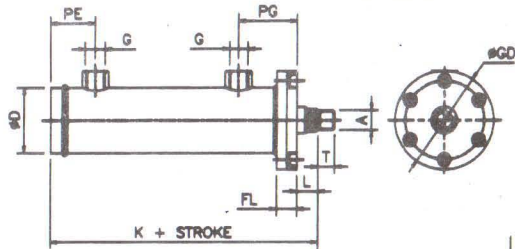

MAX. OPERATING PRESSURE : 300 kg/sq.cm
 TEMPERATURE : -30°C TO 100°C
 MEDIUM : HYDRAULIC (MINERAL OIL)
 SYMBOL :

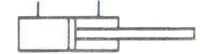

TO SUIT CUSTOMER'S SPECIFICATIONS STROKE UPTO 3000MM

RECOMMENDED STROKES AS PER IS : 10411

25,50,80,100,160,200,250,320,400 & 500MM

AN EXTENSION OF THE ABOVE RANGES MAY IF REQUIRED BE MADE USING THE R10 SERIES OF PREFERRED NUMBERS.

INTERMEDIATE TRUNNION (TM)

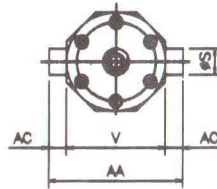
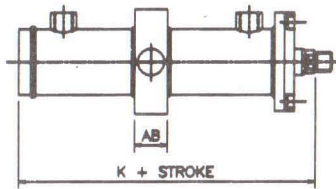

FRONT END FLANGE (FM)

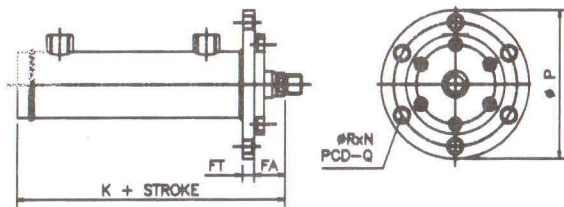

SIDE LUGS (LM)

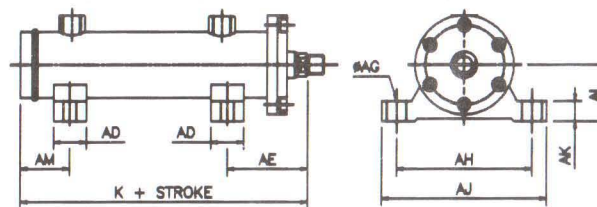

NOTE :

DUE TO CONTINUOUS IMPROVEMENTS IN DESIGN, WE RESERVE THE RIGHT TO CHANGE THE SPECIFICATION WITHOUT PRIOR NOTICE.

ALL DIMENSIONS ARE IN MM.

BASIC CYLINDER												FRONT END FLANGE (FM)					CAP END CLEVIS (CM/EM)						SIDE LUGS (LM)						INTERMEDIATE TRUNNION (TM)							
BORE #	ROD #	K	A	PE	PG	G	L	GD	T	FL	D	P	FT	FA	R	N	Q	H	D	C	B	E	CD	AD	AM	AE	AG	AH	AJ	AK	AL	AB	AC	V	AA	S
40	22 28	143	M16x1.5 M20x1.5	34	50	3/8"	20	95	22 28	24	55	155	12	34	11	6	135	35	15	20	30	34	20	40	50	60	13	110	140	15	60	30	20	85	105	20
50	28 36	152	M20x1.5 M27x2.0	34	57	3/8"	20	115	28 36	30	68	185	15	35	13	6	155	40	20	25	35	40	25	40	50	70	13	120	150	15	70	35	25	85	135	25
63	36 45	165	M27x2.0 M33x2.0	44	65	3/8"	20	162	36 45	40	82	234	20	40	13	6	204	45	25	32	40	45	30	50	60	80	17	175	215	18	90	45	35	100	170	35
80	45 56	184	M33x2.0 M42x2.0	47	70	1/2"	20	170	45 56	40	105	245	20	40	15	6	215	65	35	40	55	55	35	50	60	85	21	180	230	22	100	50	40	125	205	40
100	56 70	210	M42x2.0 M48x2.0	52	86	1/2"	25	200	56 63	50	130	280	25	50	17	6	245	70	40	45	65	72	45	60	70	100	25	190	240	25	115	55	45	155	245	45
125	70 90	225	M48x2.0 M64x3.0	60	90	3/4"	25	250	63 85	54	165	335	28	51	21	6	315	85	45	50	85	82	50	60	70	110	32	200	255	25	140	60	50	190	290	50
180	90 110	301	M64x3.0 M80x3.0	86	120	3/4"	35	300	85 95	65	210	455	35	65	32	6	380	120	70	70	95	115	80	90	100	140	35	230	300	40	165	80	65	265	365	65
200	110 140	349	M80x3.0 M100x3.0	107	135	1"	40	352	95 112	70	260	502	40	70	32	6	442	150	85	100	120	135	90	90	100	145	38	285	385	50	195	100	80	285	445	80
250	140 180	420	M100x3.0 M125x4.0	135	160	1 1/4"	50	420	112 125	90	325	610	60	80	38	6	540	180	90	100	150	155	120	110	120	180	45	290	395	70	225	130	100	395	595	100
320	180 220	495	M125x4.0 M160x4.0	185	185	1 1/2"	60	516	125 160	100	420	682	70	90	38	6	612	230	110	130	200	200	150	140	120	210	55	480	580	100	300	160	130	480	720	130