

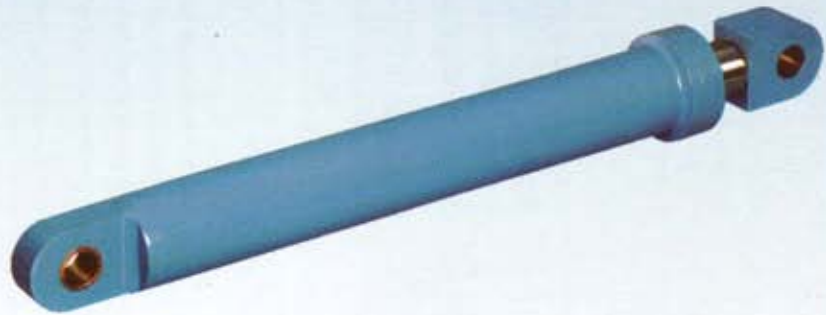

MBH SERIES

- ▶ Ideal for heavy duty applications upto 300 Kg/cm²
- ▶ Bore and Rod sizes as per CETOP, ISO and BIS standards
- ▶ Tubes Microhoned to optimum surface finish 0.4 Micron Ra or better
- ▶ Induction hardened and hard chrome plated piston rods for dent and corrosion resistance and for long seal life
- ▶ Low friction advanced sealing systems with wide working temperature range -30°C to +100°C



MANSCO HYDRAULIC CYLINDERS

ORDERING DETAILS

MBH - 50 - 22 - 500 - NC - FM - RM - 02

Heavy series

Bolted construction
Pressure upto 300 kg/cm²

Bore size

Ram size

Stroke length

Cushioning

NC - Non Cushioned
CC - Cushioned at cap end only
CH - Cushioned at head end only
CB - Cushioned at both ends

Catalogue Number

Rod End Mounting Details

RT - Male Threaded End
RF - Female Clevis
RS - Spherical Bearing Clevis
RM - Male Clevis

Cylinder Mounting Details

FM - Flange Mounting - Head End
BM - Flange Mounting - Cap End
CM - Clevis Mounting - Cap End
EM - Eye Mounting - Cap End
LM - Side Lugs Mounting
TM - Trunnion Mounting

Manufacturers :



Mansco Fluidtek Private Limited
No. 4, Sidco Industrial Estate,
Malumichampatti, Coimbatore - 641 021.
Tel : 0422 - 2655604, 2655605
Fax : 0422- 2528221
www.mantechsystems.com



BASIC CYLINDER

MBH SERIES - HYDRAULIC CYLINDERS

CAP END CLEVIS (CM/EM)

SPECIFICATIONS

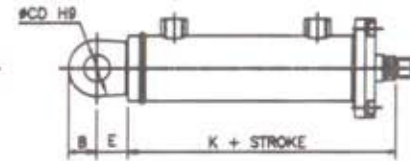
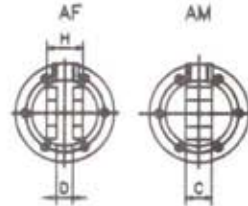
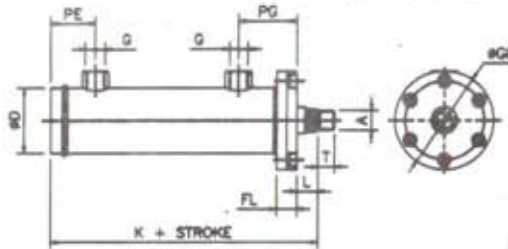

MAX. OPERATING PRESSURE : 300 kg/sq.cm
 TEMPERATURE : -30°C TO 100°C
 MEDIUM : HYDRAULIC (MINERAL OIL)
 SYMBOL :



TO SUIT CUSTOMER'S SPECIFICATIONS STROKE UPTO 3000MM
 RECOMMENDED STROKES AS PER IS : 10411
 25,50,80,100,160,200,250,320,400 & 500MM

AN EXTENSION OF THE ABOVE RANGES MAY IF REQUIRED BE MADE USING THE R10 SERIES OF PREFERRED NUMBERS.

INTERMEDIATE TRUNNION (TM)

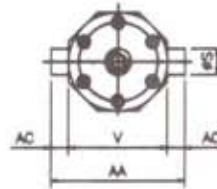
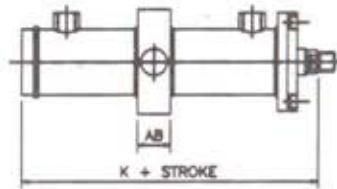

FRONT END FLANGE (FM)

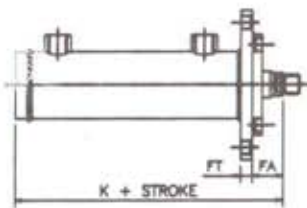

SIDE LUGS (LM)

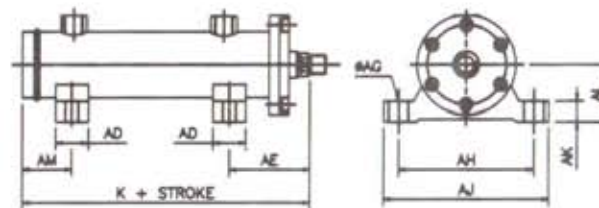

NOTE :

DUE TO CONTINUOUS IMPROVEMENTS IN DESIGN, WE RESERVE THE RIGHT TO CHANGE THE SPECIFICATION WITHOUT PRIOR NOTICE.

ALL DIMENSIONS ARE IN MM.

BASIC CYLINDER												FRONT END FLANGE (FM)					CAP END CLEVIS (CM/EM)						SIDE LUGS (LM)						INTERMEDIATE TRUNNION (TM)							
BORE #	ROD #	K	A	PE	PG	G	L	GD	T	FL	D	P	FT	FA	R	N	Q	H	D	C	B	E	CD	AD	AM	AE	AG	AH	AJ	AK	AL	AB	AC	V	AA	S
40	22 28	143	M18x1.5 M20x1.5	34	50	3/8"	20	95	22 28	24	55	155	12	34	11	6	135	35	15	20	30	34	20	40	50	60	13	110	140	15	60	30	20	85	105	20
50	28 36	152	M20x1.5 M27x2.0	34	57	3/8"	20	115	28 36	30	68	165	15	35	13	6	155	40	20	25	35	40	25	40	50	70	13	120	150	15	70	35	25	85	135	25
63	36 45	165	M27x2.0 M33x2.0	44	65	3/8"	20	162	36 45	40	82	234	20	40	13	6	204	45	25	32	40	45	30	50	60	80	17	175	215	18	80	45	35	100	170	35
80	45 56	184	M33x2.0 M42x2.0	47	70	1/2"	20	170	45 56	40	105	245	20	40	15	6	215	65	35	40	55	55	35	50	60	85	21	180	230	22	100	50	40	125	205	40
100	56 70	210	M42x2.0 M48x2.0	52	86	1/2"	25	200	56 63	50	130	280	25	50	17	6	245	70	40	45	65	72	45	60	70	100	25	190	240	25	115	55	45	155	245	45
125	70 90	225	M48x2.0 M64x3.0	60	90	3/4"	25	250	63 85	54	165	335	28	51	21	6	315	85	45	50	65	82	50	60	70	110	32	200	255	25	140	60	50	190	290	50
160	90 110	301	M64x3.0 M80x3.0	66	120	3/4"	35	300	85 95	65	210	455	35	65	32	6	360	120	70	70	95	115	80	90	100	140	35	230	300	40	165	80	65	265	365	65
200	110 140	349	M80x3.0 M100x3.0	107	135	1"	40	352	95 112	70	260	502	40	70	32	6	442	150	85	100	120	135	90	90	100	145	38	285	385	50	195	100	80	285	445	80
250	140 180	420	M100x3.0 M125x4.0	135	160	1 1/4"	50	420	112 125	90	325	610	60	80	38	6	540	180	90	100	150	155	120	110	120	180	45	290	385	70	225	130	100	365	595	100
320	180 220	495	M125x4.0 M160x4.0	165	185	1 1/2"	60	516	125 160	100	420	682	70	90	38	6	612	230	110	130	200	200	150	140	120	210	55	480	580	100	300	160	130	460	720	130